

CV-BSS Series Surface Mount Type Miniature, High CV products 5.4mm height



CV-BSS series is smaller size in diameter than CV-BS series.

(ex. $\phi 6.3 \rightarrow \phi 5$)

CV-BSS series contributes toward miniaturization of any products.

Solvent proof (within 2 minutes).



Specifications

Items	Specifications					
Rated voltage (V)	6.3	10	16	25	35	50
Category temperature range (°C)	-40 to +85					
Capacitance tolerance (%)	±20 (120Hz/20°C)					
Tangent of loss angle (tan δ) (MAX.) (120Hz/20°C)	0.28	0.24	0.20	0.16	0.14	0.12
Leakage current (L.C.) (μA/after 2min.) (MAX.)	The greater value of either 0.01CV or 3					
Impedance (120Hz) ratio at low temperature (MAX.)	Z _{-25°C} /Z _{20°C}	4	3	2	2	2
	Z _{-40°C} /Z _{20°C}	10	8	6	4	4
Endurance 85°C 2000hrs. rated voltage applied	ΔC/C	Within ± 25% of the initial value				
	tan δ	≤ Twice the initial standard				
	L.C.	≤ The initial standard				

Dimensions

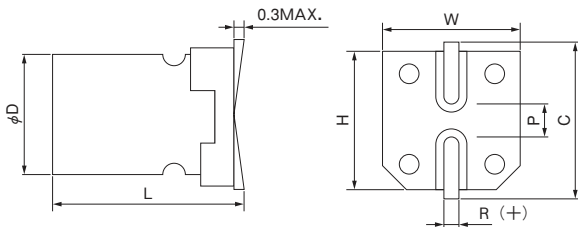

(Unit :mm)

D ^{+0.5MAX.}	L ^{+0.1 -0.2}	W ^{±0.2}	H ^{±0.2}	C ^{±0.2}	R	P ^{±0.2}
4	5.4	4.3	4.3	5.0	0.5 to 0.8	1.0
5	5.4	5.3	5.3	6.0	0.5 to 0.8	1.4
6.3	5.4	6.6	6.6	7.3	0.5 to 0.8	2.2

Size List, Maximum Permissible Ripple Current

μF \ V	6.3		10		16		25		35		50	
4.7											4×5.4	18
10							4×5.4	20	4×5.4	20	5×5.4	27
22			4×5.4	28	4×5.4	28	5×5.4	35	5×5.4	36	6.3×5.4	40
33	4×5.4	31	4×5.4	32	5×5.4	40	5×5.4	42	6.3×5.4	58		
47	4×5.4	36	5×5.4	43	5×5.4	44	6.3×5.4	65				
56	5×5.4	46	5×5.4	46	5×5.4	48	6.3×5.4	68				
100	5×5.4	47	5×5.4	50								
150	6.3×5.4	71	6.3×5.4	76								
220	6.3×5.4	74										

Case size ; φ D×L (mm)

Ripple current
mA r.m.s.
(120Hz, 85°C)

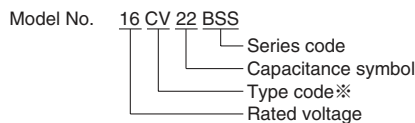

※Type code

Environment-friendly capacitors Pb free lead finishing	Sn-Pb lead finishing
CE	CV